

*** BASE CAMP SUPPORT ***

* LAVATORY * FOUR STATION

Starline's Four Station Lavatory is a practical solution for diverse settings where traditional facilities are unavailable.

This mobile unit features four individual stations, each equipped with a flushing toilet, sink with heated running water and a mirror.



For more information on this product please call (905) 822-4850 email hello@starlinetrailers.com or visit starlinetrailers.com

* As part of our ongoing commitment to continuous improvement, we regularly update our fleet and as such, size, layout and available features may differ from unit to unit within the same asset category.

STARLINE
PRODUCTION RENTALS INC.

* FOUR STATION LAVATORY SPECIFICATIONS *

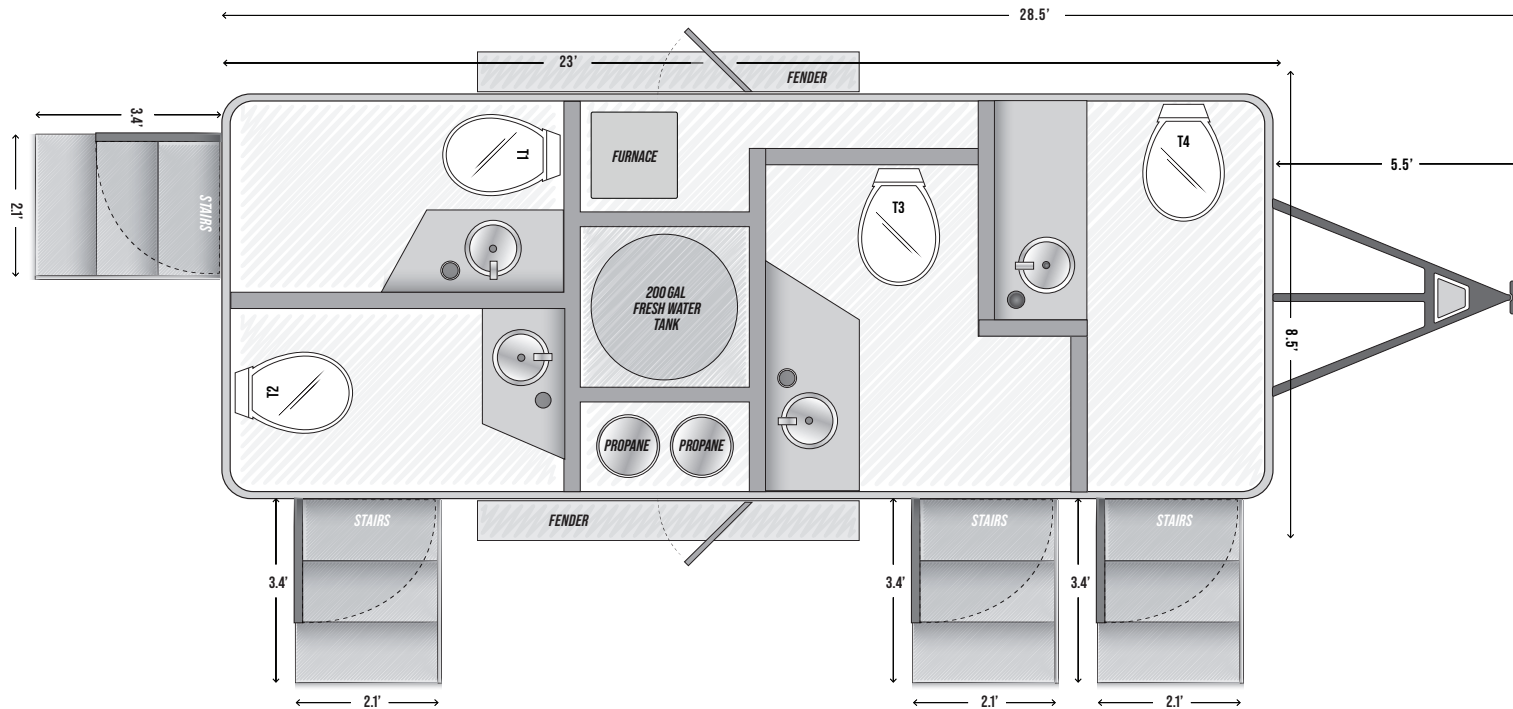

Interior Features

- * 4 spacious gender neutral compartments
- * Porcelain flushing toilets
- * Waterless urinals in men's compartment
- * Mirrored vanities with solid surface counters
- * Stainless steel sinks with chrome metered faucets and hot water
- * Pebble finish walls + locking cabinets with storage space
- * Integrated trash receptacles + chrome coat hooks
- * Soap, hand sanitizer, paper towel + toilet tissue dispensers
- * Commercial grade flooring
- * Bright, interior LED lighting with occupancy sensors
- * A/C and propane ducted furnace with additional electric heat for cooling + heating

Exterior Features

- * Classy neutral white exterior
- * Powered roof vents
- * 'In Use' lights + porch lights at each entry
- * Folding, self-leveling non-skid entry steps with stainless steel handrail
- * Aluminum rims + stabilizing jacks
- * Roof mounted solar panels + on-board battery charger for basic summer operation
- * Onboard 7K Honda quiet generator
- * Onboard 2 x 40lb propane cylinders

Capacity

- * Approximately 525 uses
- * Fresh Water Tank: 200 Gallon/760 Litres
- * Grey Water Tank: 600 Gallon/2270 Litres

Dimensions

- * L x W x H: 28.5' x 8.5' x 12'
- * Dry weight: Approx. 6900 lbs/3130 kg
- * Wet weight: 8200 lbs/3720 kg

Power + Towing

- * 1 x 50A power cord with cam-lock converter [available on request]
- * 2 - 5/16 ball hitch with 7 pin plug

For more information on this product please call (905) 822-4850 email hello@starlinetrailers.com or visit starlinetrailers.com

* As part of our ongoing commitment to continuous improvement, we regularly update our fleet and as such, size, layout and available features may differ from unit to unit within the same asset category.